

STATE OF ARKANSAS
STATE HIGHWAY COMMISSION

FED. DIST. NO.	STATE	FED. AID PROJ. NO.	FISCAL YEAR	SHEET NO.	TOTAL SHEETS
6	ARK.	271-A	1930	1	6

FISCAL YEAR	JOB NO.	SHEET NO.	TOTAL SHEETS
1930	3-126	1	6

INDEX OF SHEETS

Sheet No. 1 Drwg. No. 1995 Title Sheet.
" " 2 " " 1996-A Layout Sheet (1 of 2) of Br. No. 899 1/2
" " 3 " " 1997 " " (2 " 2) " " " 899 1/2
" " 4 " " 1998-A Details of Raising & Re-decking Br. No. 899 1/2
" " 5 " " 1999 Layout of Br. No. 900
" " 6 " " 2273 Details of Standard 30' R.C.D. Girder on Concrete Pile Bents, 20' Clear Roadway.

Note: Two Federal Aid Marker plates of approved design and furnished by the state to be placed on each bridge.

PLAN OF PROPOSED BRIDGES
OVER
CADDO RIVER
CLARK COUNTY

ROUTE 51 SEC. 2
JOB NO 3126
FEDERAL AID PROJECT NO. 271-A

QUANTITIES

Item No.*11	Clearing	1 Acre
" " *12	Earth Excavation	1,120 Cu.Yds.
" " *17	Borrow	9,800 " "
" " 54	" " " " " " " "	Cu.Yds.
" " 55	Reinforcing Steel	1102.05 " "
" " 68	Precast Concrete Piling	276,912 Lbs.
" " 68	Rip Rap	5184 Lin Ft.
" " 74	Conc. Railing for Structures	156 Cu.Yds.
" " 74	Repairing Existing Structure	2069 Lin. Ft.
" " 74	Repairing Existing Structure	1 Lump Sum

Note - Items marked thus * are non-participating in Federal Aid

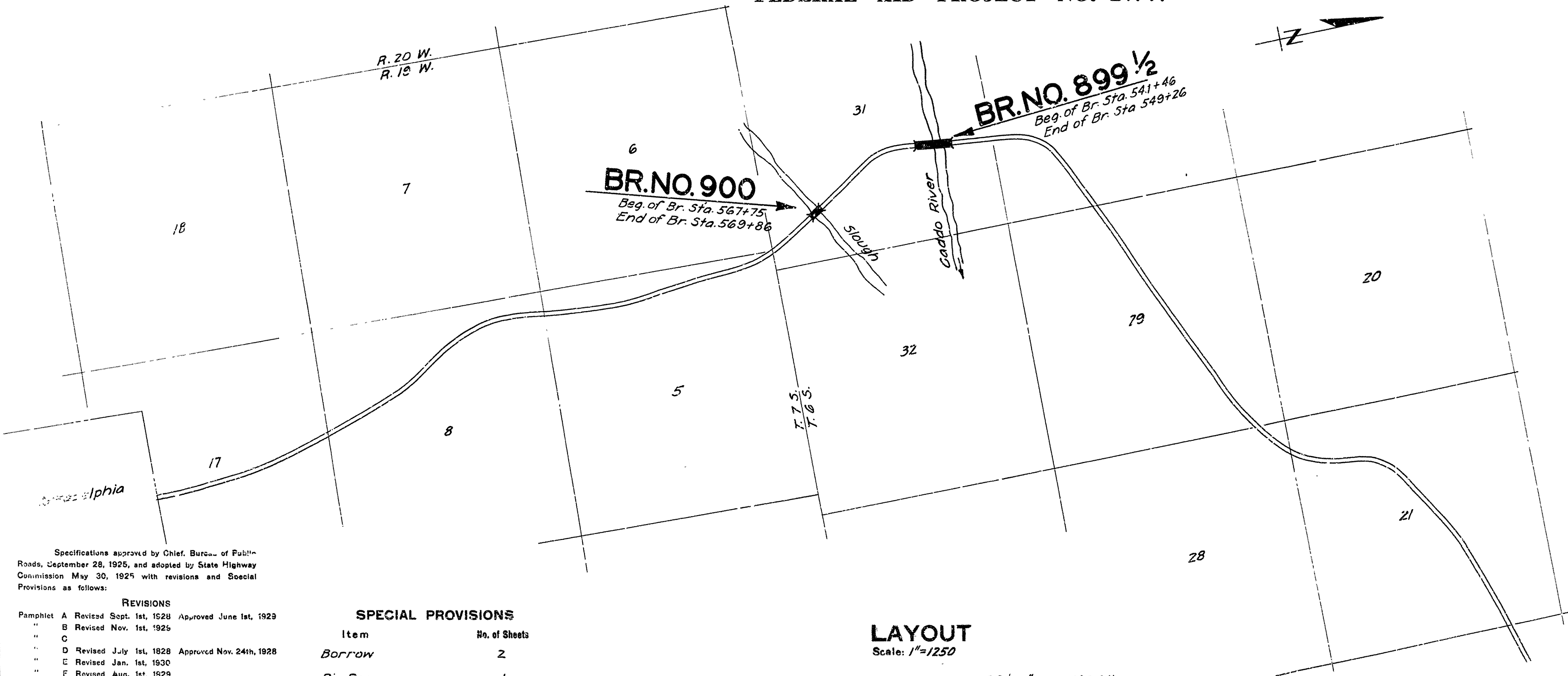

Specifications approved by Chief, Bureau of Public Roads, September 28, 1925, and adopted by State Highway Commission May 30, 1925 with revisions and Special Provisions as follows:

REVISIONS		
Pamphlet	A	Revised Sept. 1st, 1928 Approved June 1st, 1929
"	B	Revised Nov. 1st, 1925
"	C	"
"	D	Revised July 1st, 1928 Approved Nov. 24th, 1928
"	E	Revised Jan. 1st, 1930
"	F	Revised Aug. 1st, 1929
"	G	Revised June 1st, 1929
"	H	Revised Jan. 1st, 1930
"	I	"
"	J	Revised Jan. 1st, 1929 Approved June 1st, 1929
"	K	"
"	L	Revised Jan. 1st 1929 Approved June 1st, 1929

SPECIAL PROVISIONS		
Item	No. of Sheets	
Borrow	2	
Rip Rap	1	
Repairing Existing Structure	1	
Engineers Office	1	

LAYOUT
Scale: 1"=1250'

LENGTH OF PROJECT	= 991'-6" = 0.187 MI.
LENGTH OF BRIDGES	= 981'-6" = 0.183 MI.
LENGTH OF EMBANKMENT	= 627'-6" = 0.118 MI.
LENGTH OF JOB	= 1379'-0" = 0.263 MI.

10-29-30
Added Length. HB.

APPROVED
CHIEF ENGINEER - U. S. BUREAU OF PUBLIC ROADS
APPROVED
DISTRICT ENGINEER - U. S. BUREAU OF PUBLIC ROADS
APPROVED
CHIEF - U. S. BUREAU OF PUBLIC ROADS
APPROVED
CHAIRMAN - STATE HIGHWAY COMMISSION
APPROVED
STATE HIGHWAY ENGINEER

BRIDGE ENGINEER

BRIDGES NO. 899 1/2 & 900

DRAWING No. 1995

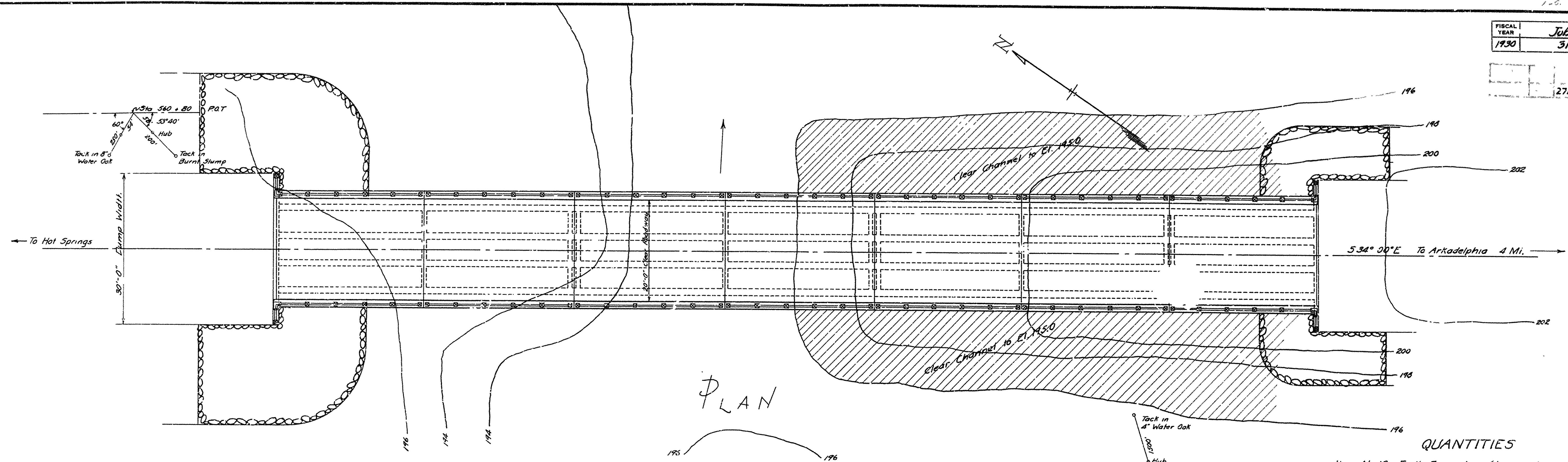

PLAN

Note: Rof W 40' each side of \pm from Sta. 566+85 to Sta. 571+50.
Total Length of Bridge = 211'-0"

QUANTITIES

Item No. 12	Earth Excavation (clearing channel)	11,200 c.y.
" No. 17	Borrow	2400 c.y.
" No. 54	Class "5" Concrete	23,907 c.y.
" No. 55	Reinf. Steel	57,665 Lbs.
" No. 68	Precast Conc. Piling	864 Lin. Ft.
" No. 69	Rip Rap	100 c.y.
" No. 74	Conc. Handrail	440 Lin. Ft.

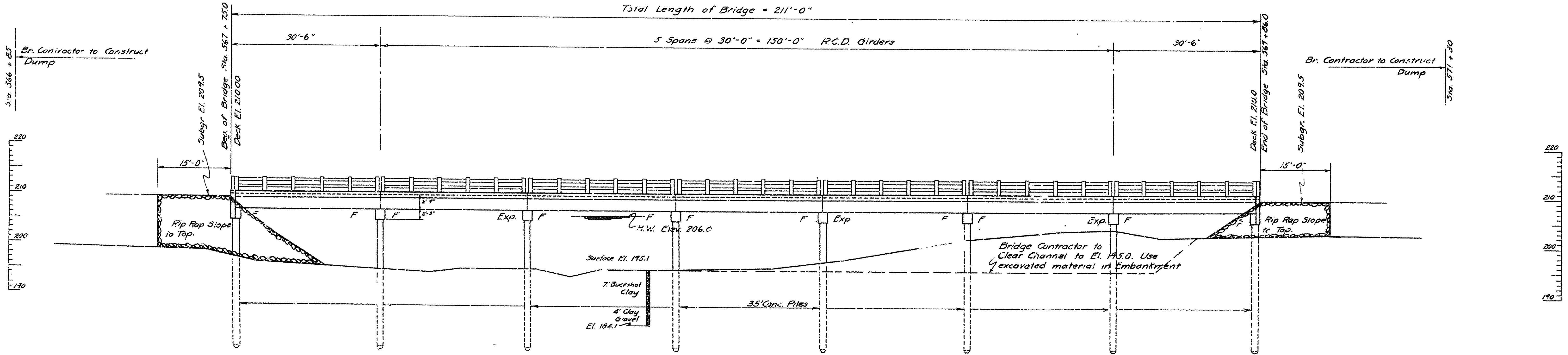

ELEVATION

General Notes : Length of Piling shown are assumed for estimating quantities only. Actual lengths are to be determined in the field. Bridge Contractor to clean channel and construct Embankment at Bridge Ends.

LAYOUT OF
CADDO RIVER RELIEF BRIDGE
HOT SPRINGS-ARKADELPHIA ROAD
CLARK COUNTY
ROUTE 17 SEC. 14
ARKANSAS STATE HIGHWAY COMMISSION
LITTLE ROCK, ARK.
Drawn By: E.A.W. Date: 2-2-30
Traced By: M.G.S. Date: 2-15-30
Checked By: E.S.V. Date: 2-17-30
Scale: 1 in. = 10 ft.
BRIDGE NO. 900 DRAWING NO. 1779

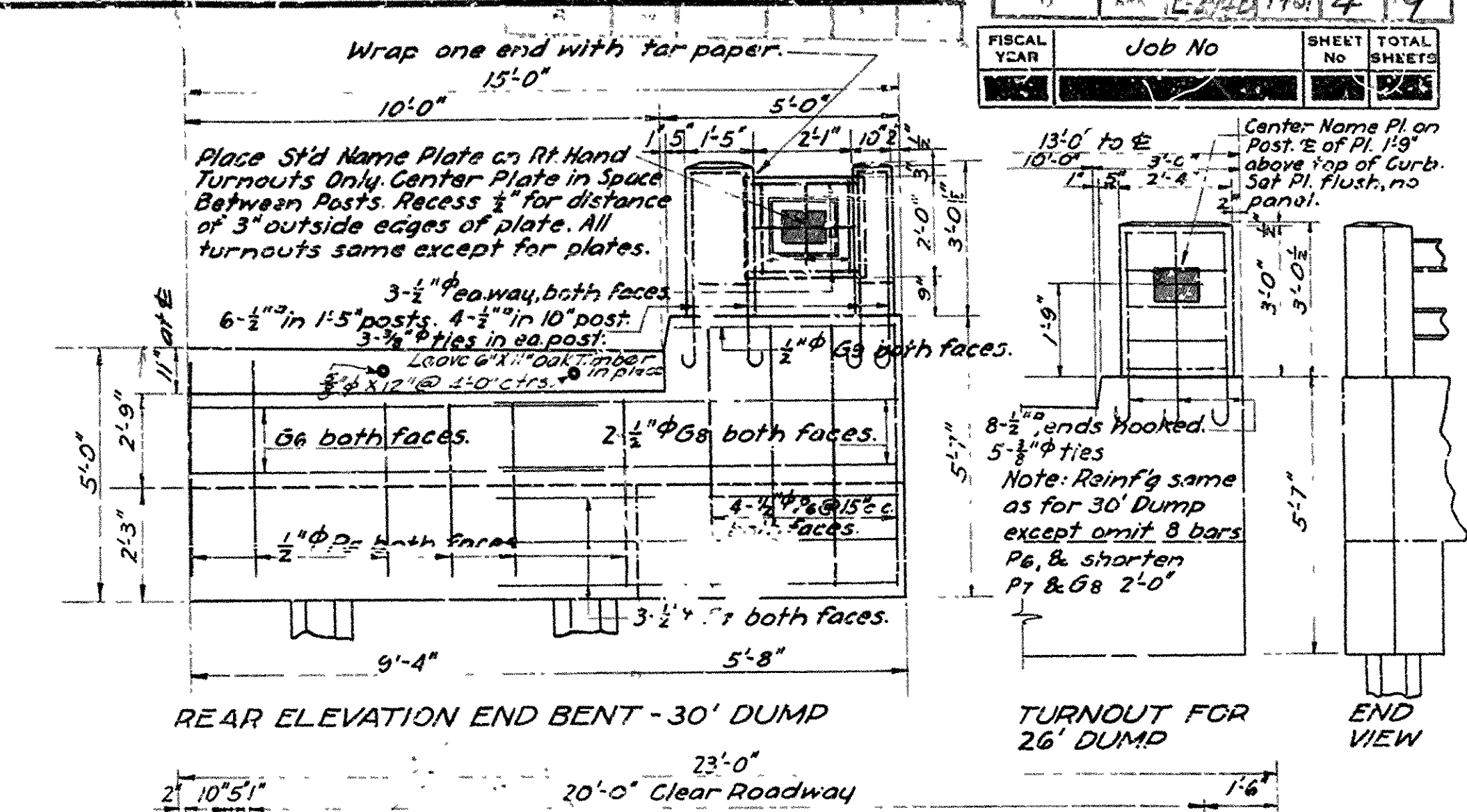

REAR ELEVATION END BENT - 30' DUMP

TURNOUT FOR
26' DUMP

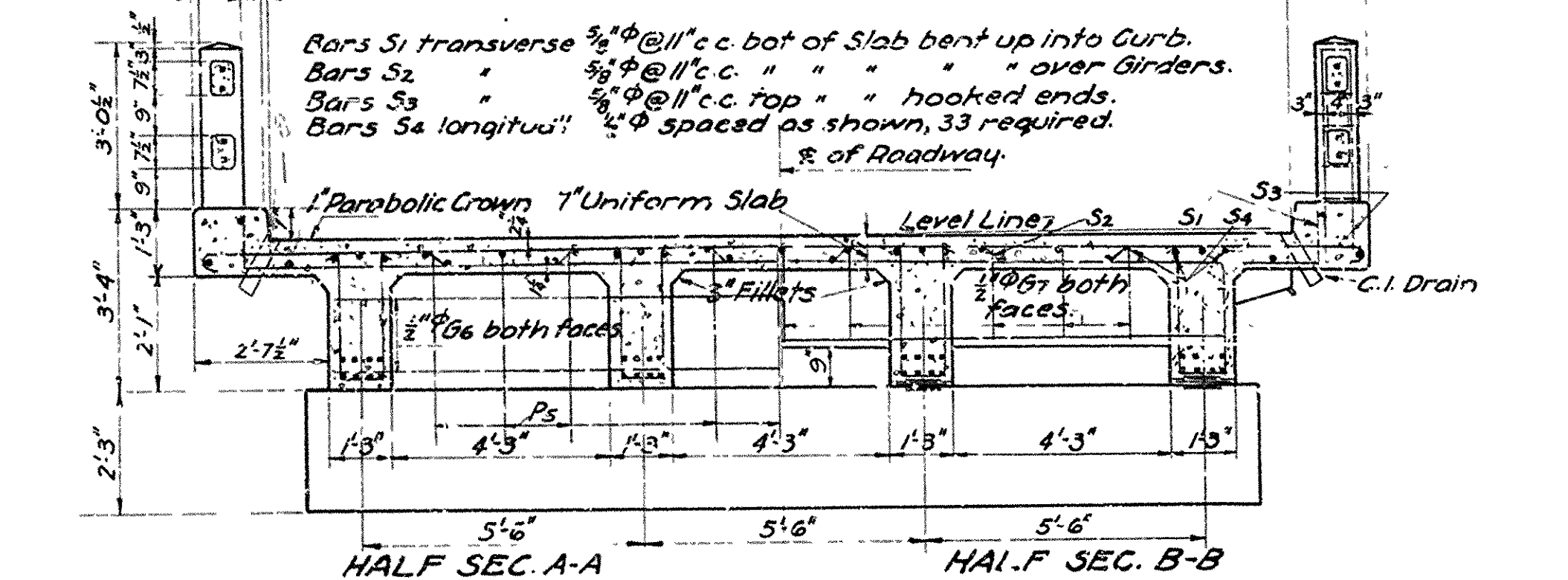

3-6
HALF SEC. A-A

SEC. ON E

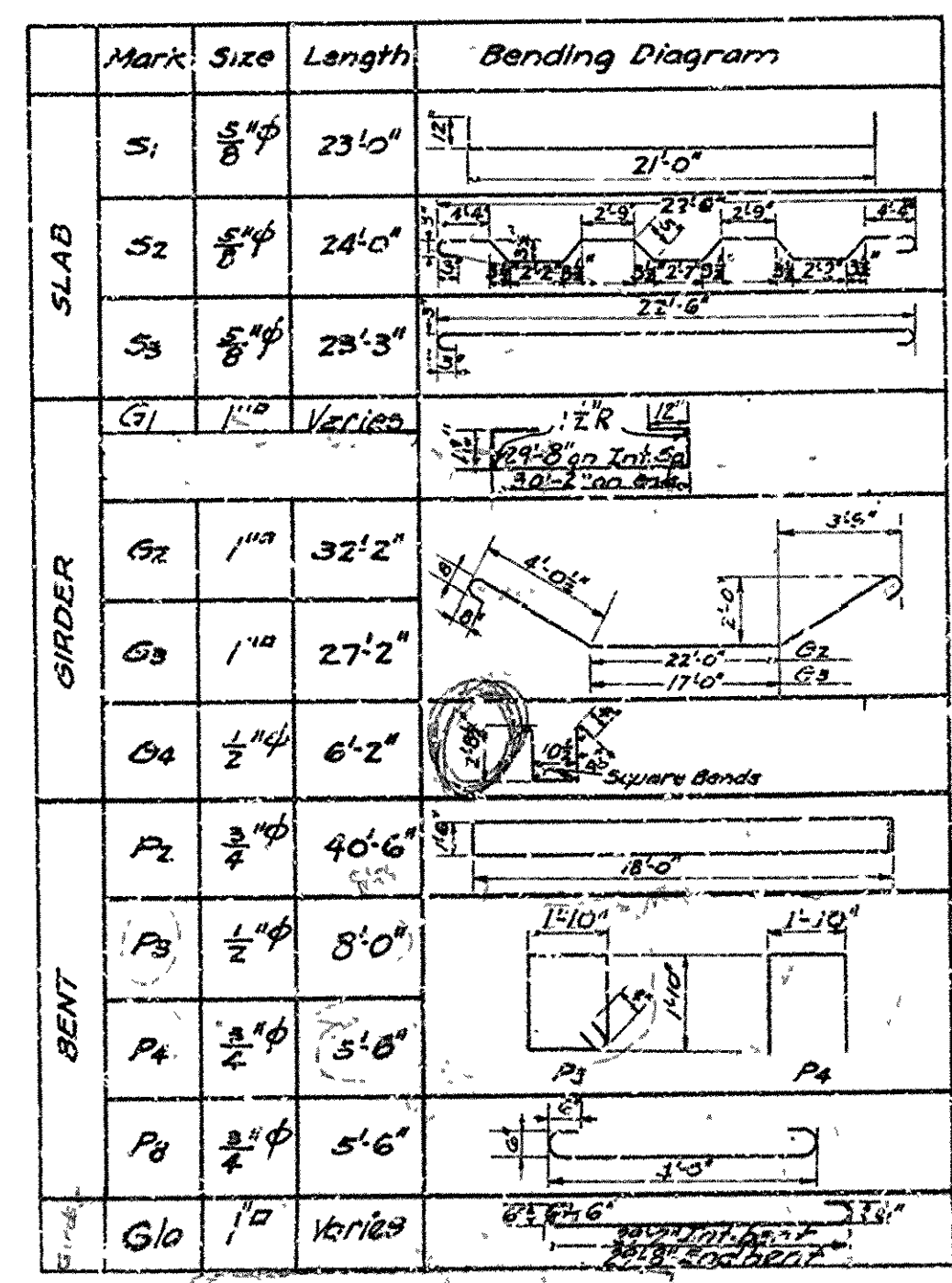

DETAIL OF CONC. PILE

PILE DIMENSIONS & REINFB

	L	D	P	Upr. Bars	Spiral
Totals	16"	8"	9"	8- $\frac{1}{2}$ " ϕ	4 wire
Totals	16"	8"	9"	8- $\frac{3}{8}$ " ϕ	4 wire

Case holes for 1/4 bolts.

Top Plate

BRIDGE ENGINEER

General Notes

All exposed corners to have $\frac{3}{4}$ " chamfer unless otherwise noted.

Precast concrete handrail to be 1:1:2 mix. Max aggregate is $\frac{5}{8}$ ".

All concrete, except handrail, to be Class "S".

Reinforcing steel to be deformed bars of structural or intermediate grade.

Shop list and bending diagrams must be submitted by Contractor before fabrication is begun.

Roadway drains and expansion devices to be paid for at unit price bid for reinforcing steel.

Specifications: Arkansas Standard Road & Bridge Specifications, adopted May 30, 1925 and revised.

Unit Stresses: $f_s = 16,000 \frac{lb}{sq. in.}$, $f_c = 750 \frac{lb}{sq. in.}$, $n = 15$

Loading 1115

Class 4-3030 by Noe

DETAIL OF
STANDARD 30' R.C.D. GIRDER
4 GIRDER TYPE-4 PILE BENT
20 0 CLEAR ROADWAY

ARKANSAS STATE HIGHWAY COMMISSION
LITTLE ROCK, ARK.

Drawn By: E.A.K. Date: 3-7-30
 Traced By: R.S. Date: 3-12-30
 Checked By: _____ Date: _____

Scale: As noted.

BRIDGE NO. _____ DRAWING NO. 2273